

Question 1: The original courtyard gate is indented approximately 5-6 feet. **Are you in favor of allowing owners to square off their gates, thereby adding an 15-18 square feet of courtyard space?**

Original Fence/Closet Design

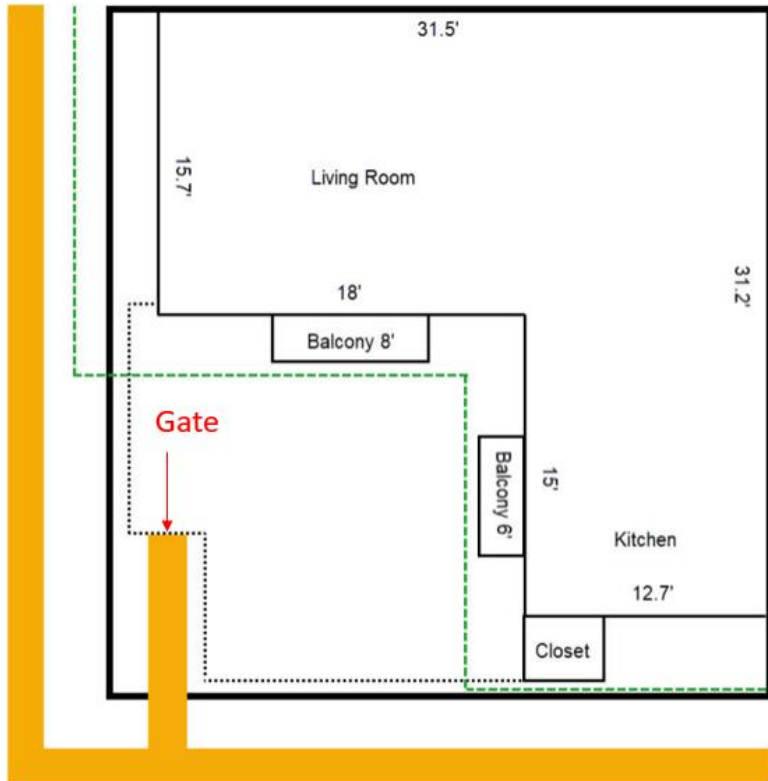

Squared Off Gate

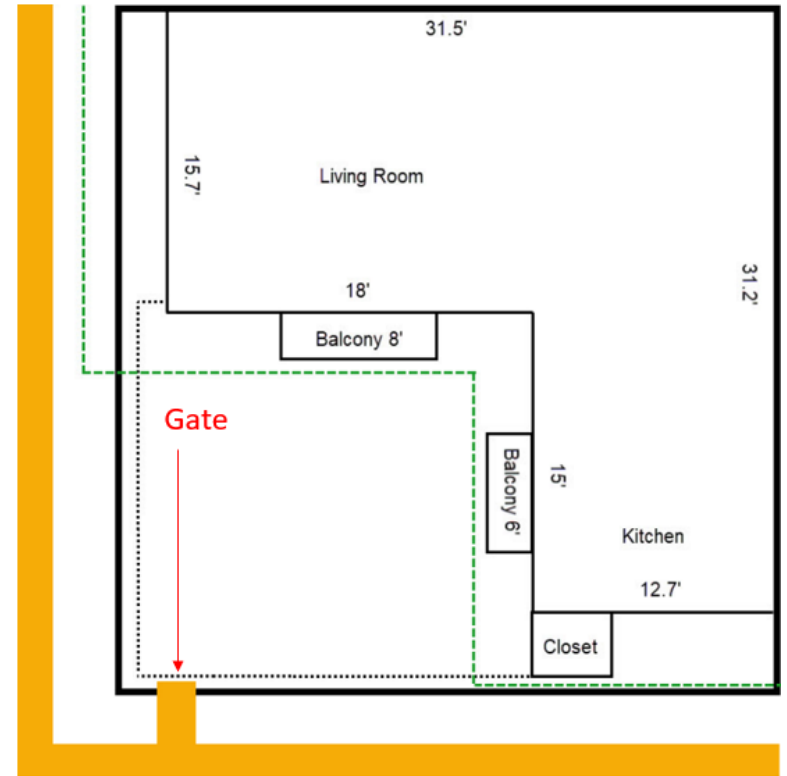

Legend:

Line Style	Picture	Description
Thick Black Line		Property line on your survey
Thin Black Line		Unit wall and balcony lines
Dashed Green Line		Roof line; distance between roof line and property line varies by unit. See your survey for exact measurements.
Dotted Black Line		Fence line
Thin Red Line		Closet walls
Thick Orange Line		Sidewalk

Note: Drawings not to scale

Question 2: The original fence line on the kitchen side aligns with the unit's property line. The fence line on the living room side does not. **Are you in favor of allowing owners to move their living room side fence line out to their property line?**

Original Fence/Closet Design

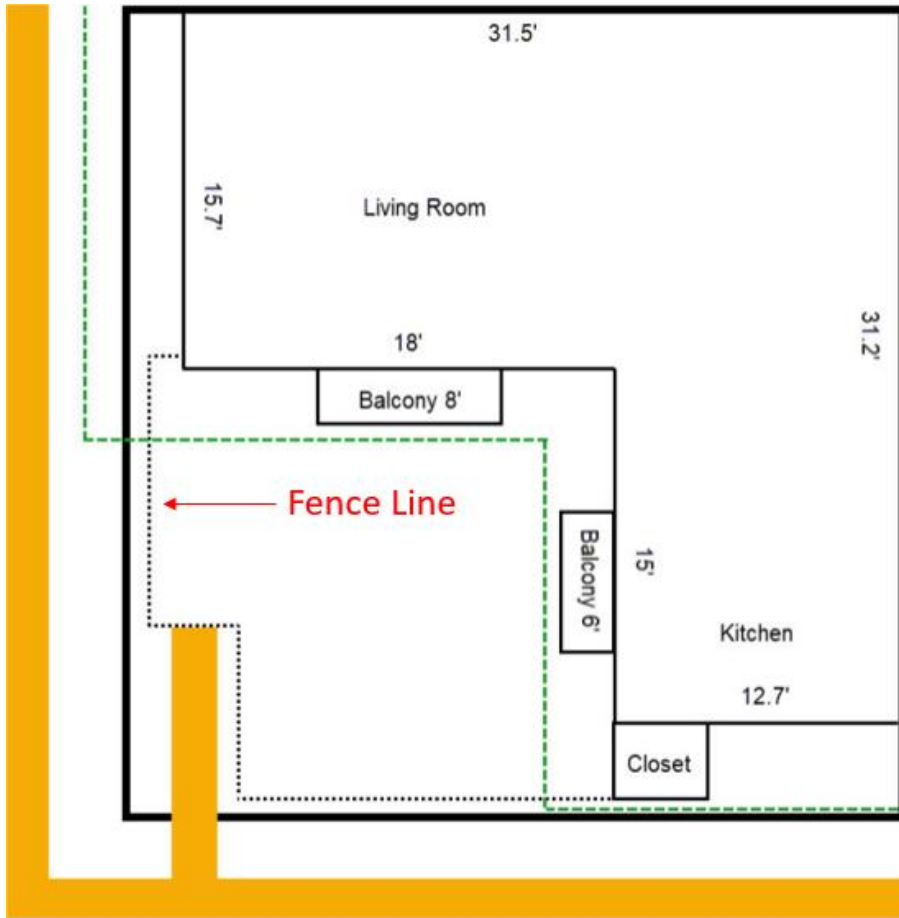

Fence Line Only

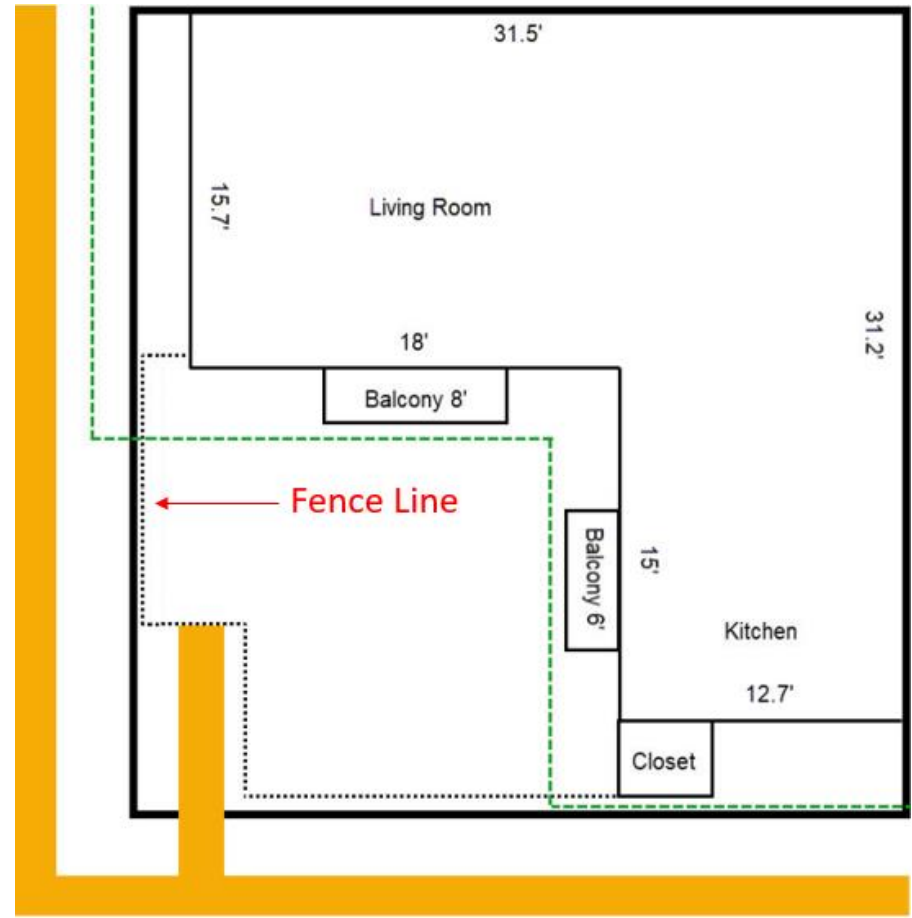

Note: Drawings not to scale

See next page for combined fence line and gate example



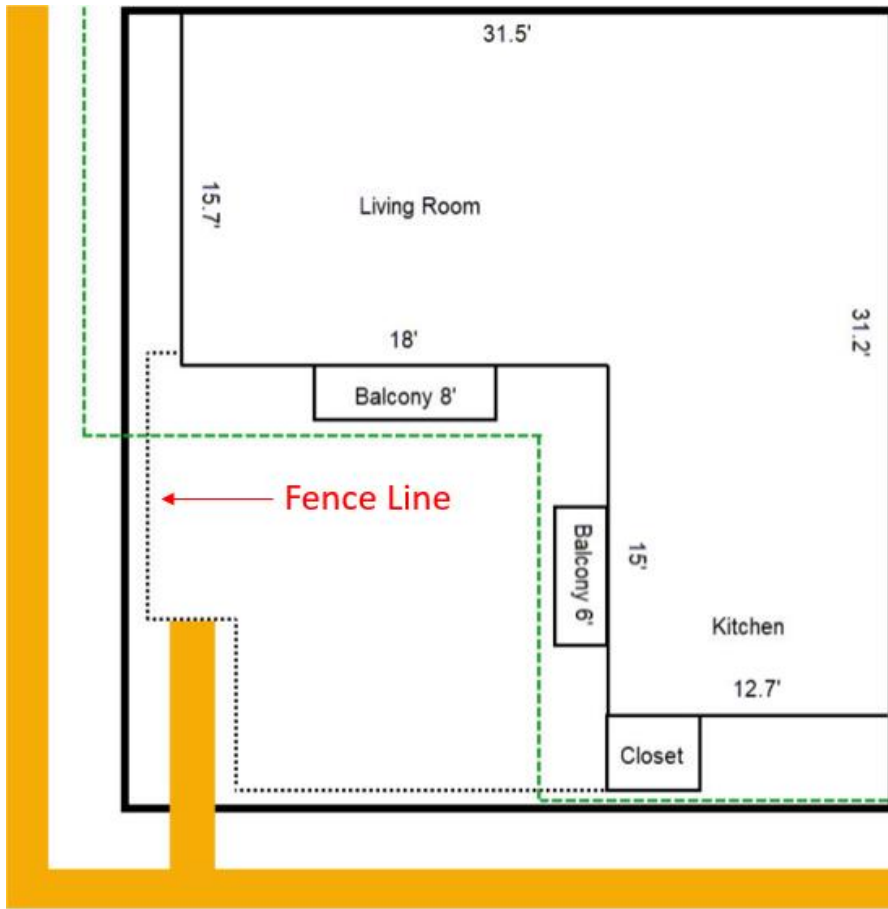

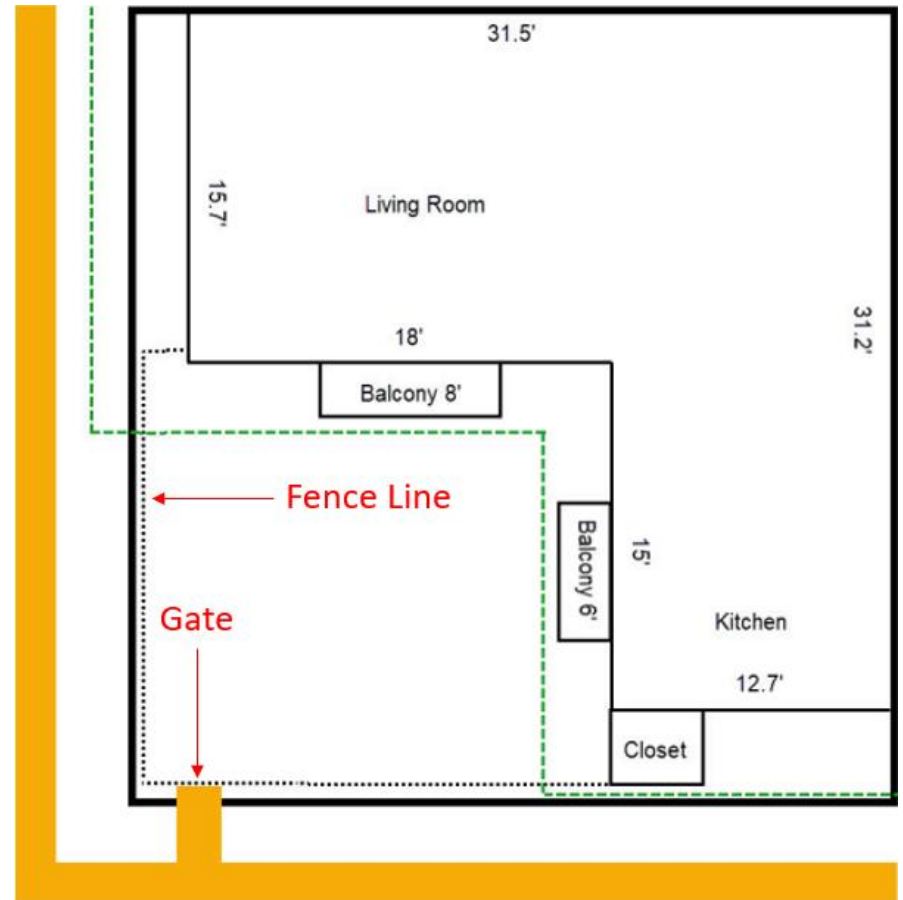

Original Fence/Closet Design



Fence Line & Gate



Legend:

Line Style	Picture	Description
Thick Black Line		Property line on your survey
Thin Black Line		Unit wall and balcony lines
Dashed Green Line		Roof line; distance between roof line and property line varies by unit. See your survey for exact measurements.
Dotted Black Line		Fence line
Thin Red Line		Closet walls
Thick Orange Line		Sidewalk

Note: Drawings not to scale

Question 3: The original courtyard closet design was a small approximately 3x3 enclosure on the kitchen side. Current rules allow the owner to extend that closet onto the courtyard under the overhang and also allow the addition of a second closet on the living room side under the overhang as long as it matched the kitchen side. It did not allow for extending either closet to cover the decorative brick walls on either side of the building. **Are you in favor of allowing owners to extend the living room side closet to a depth that matches the original kitchen side closet providing the existing brick is not removed or damaged and all utility, sewer cleanout, or water meter setbacks are adhered to?**

Original Max Closet Design

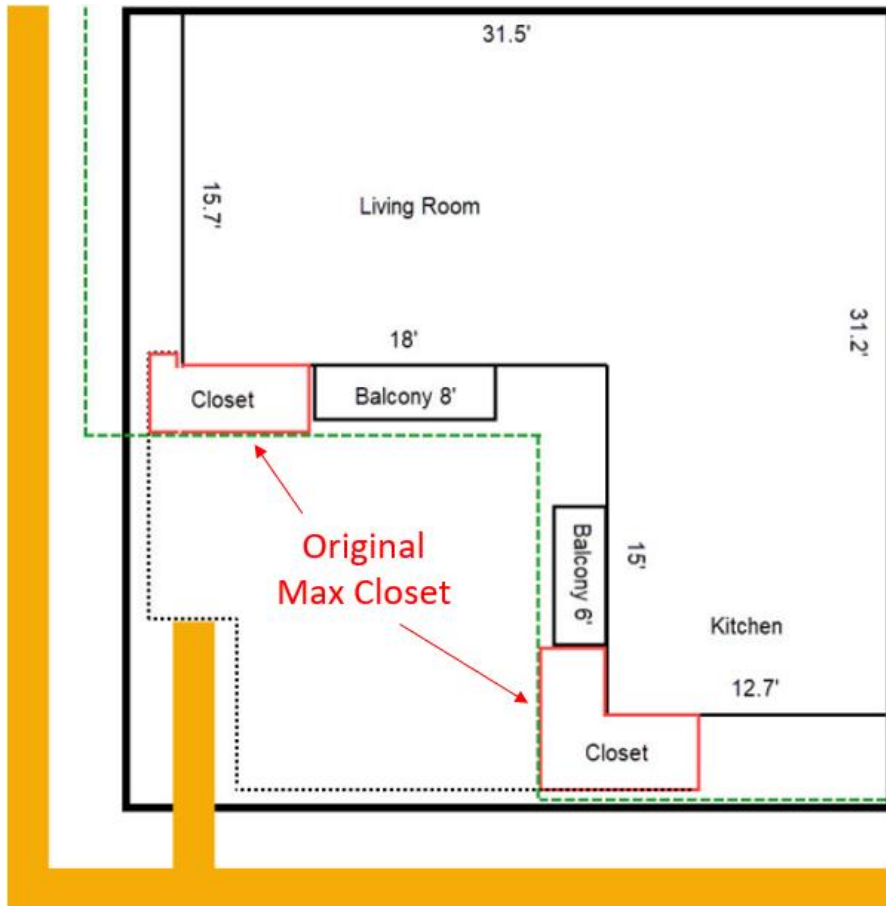

Expanded Living Room Closet

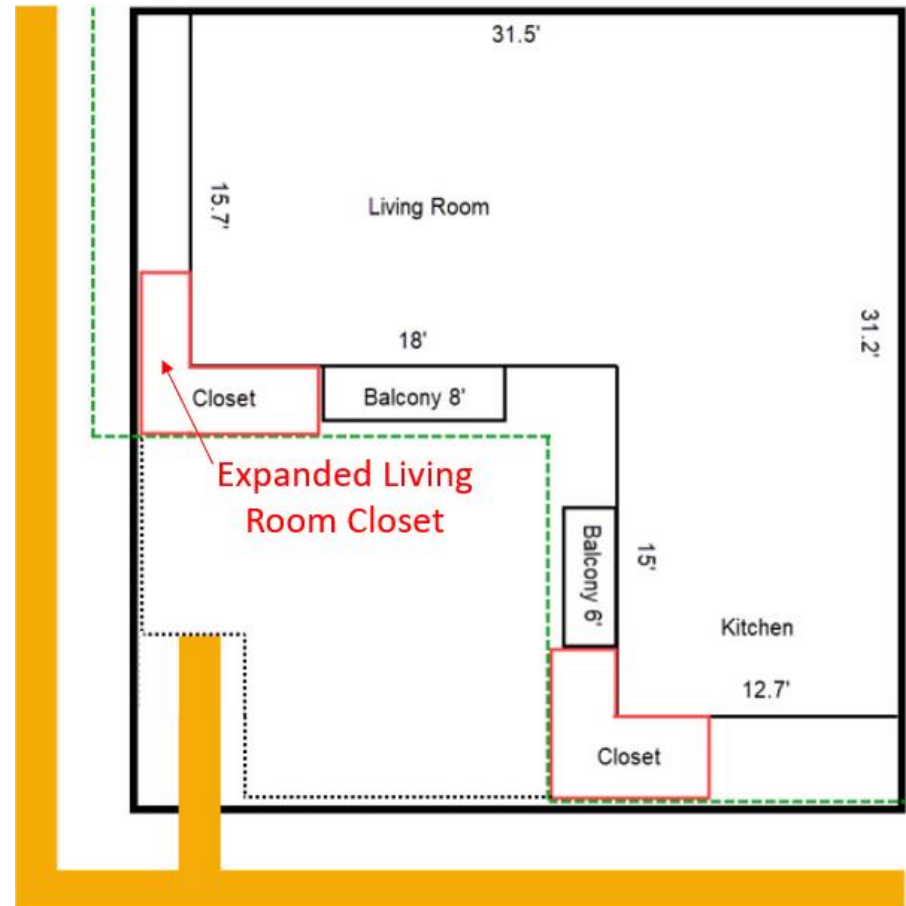

Note: Drawings not to scale

See next page also for combined expanded LR closet and gate example



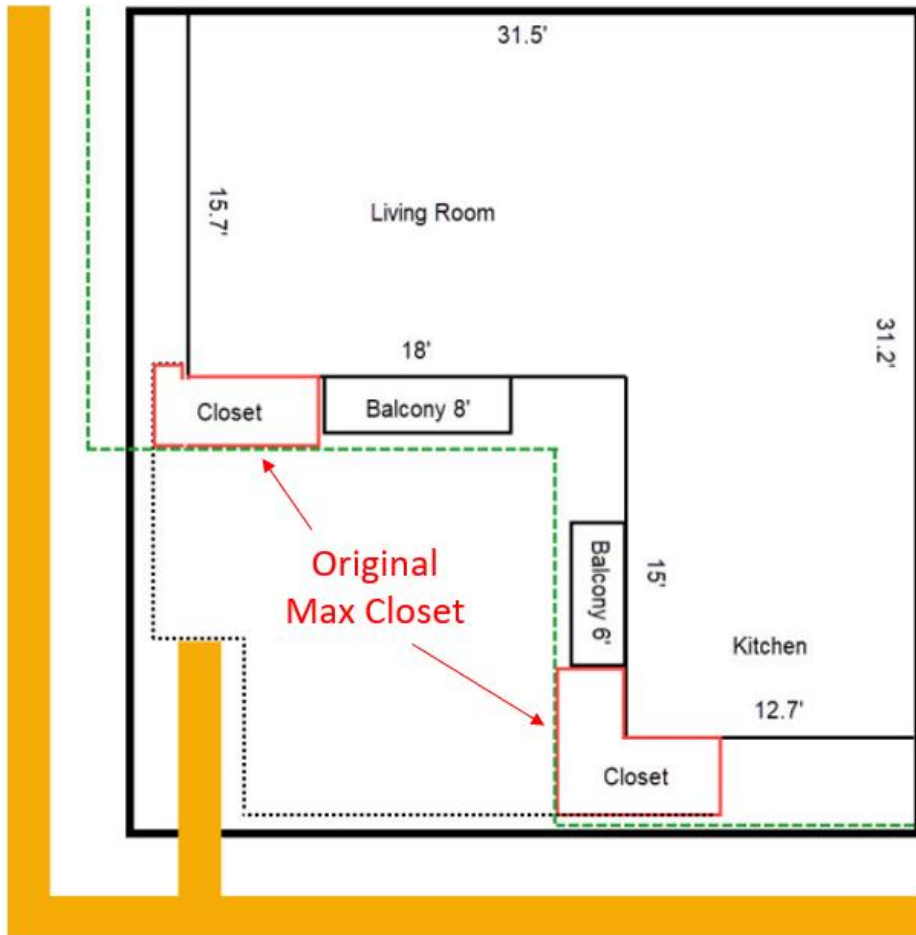



Original Fence/Closet Design



Expanded Living Room Closet & Gate



Legend:

Line Style	Picture	Description
Thick Black Line		Property line on your survey
Thin Black Line		Unit wall and balcony lines
Dashed Green Line		Roof line; distance between roof line and property line varies by unit. See your survey for exact measurements.
Dotted Black Line		Fence line
Thin Red Line		Closet walls
Thick Orange Line		Sidewalk

Note: Drawings not to scale

Question 4: Many owners are asking for significantly more outdoor storage space and want to expand both the kitchen side and living room side closets along the brick wall. **Are you in favor of allowing owners to extend both the kitchen side and living room side closets to a max of approximately 95 inches from the front corner of the mansards providing the existing brick is not removed or damaged and all utility, sewer cleanout, or water meter setbacks are adhered to?**

Original Max Closet Design

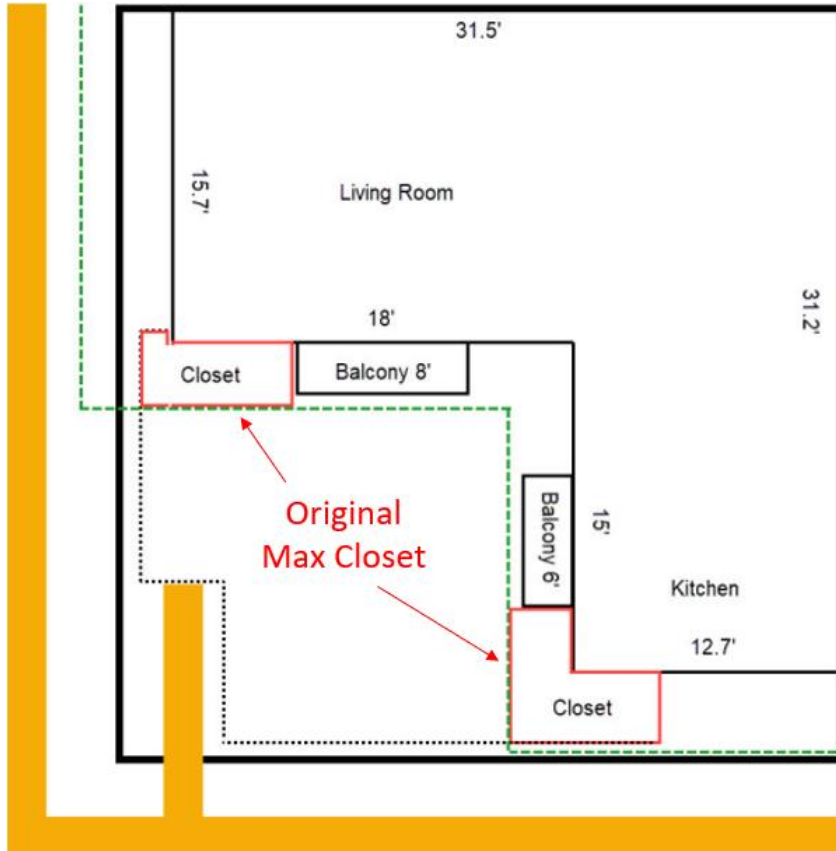

Extra Expanded Closets

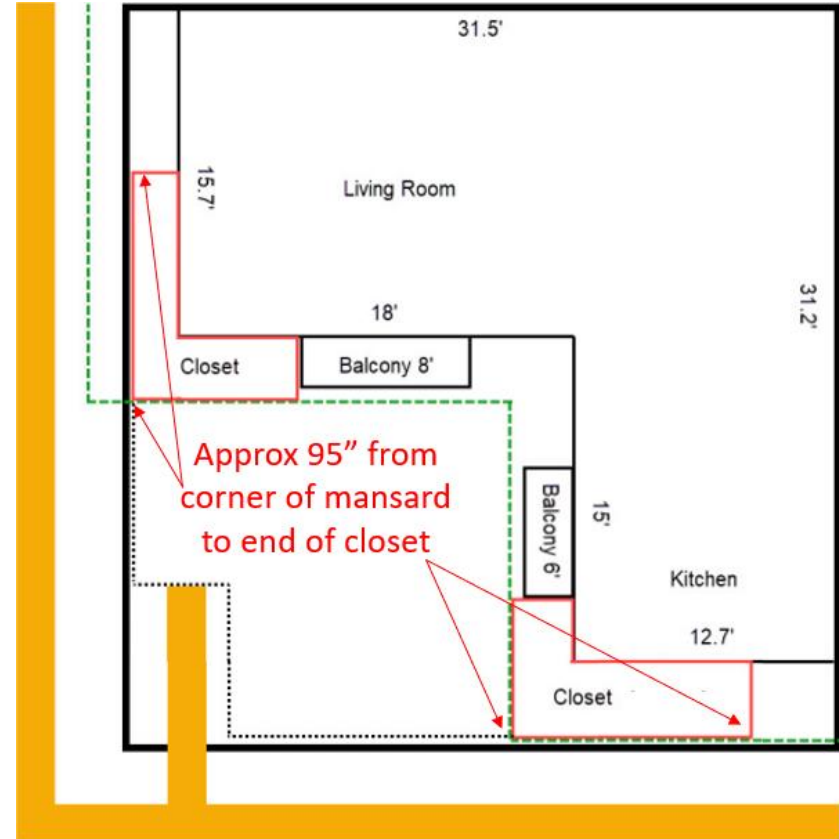

Note: Drawings not to scale

See next page for combined 95" expanded LR closet and gate example



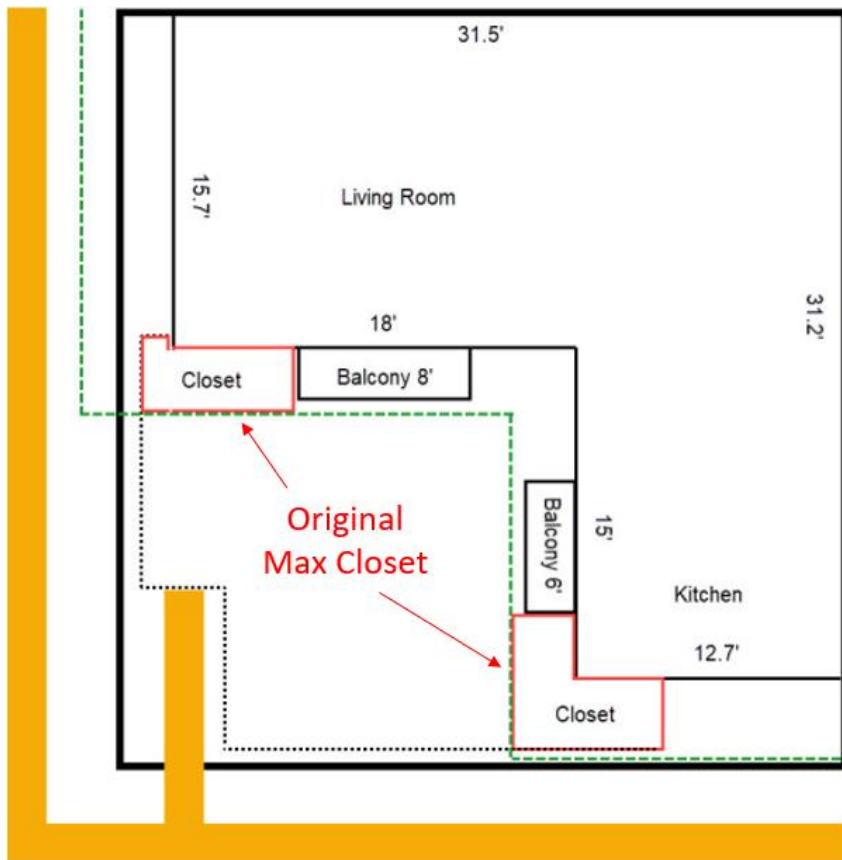

Original Fence/Closet Design

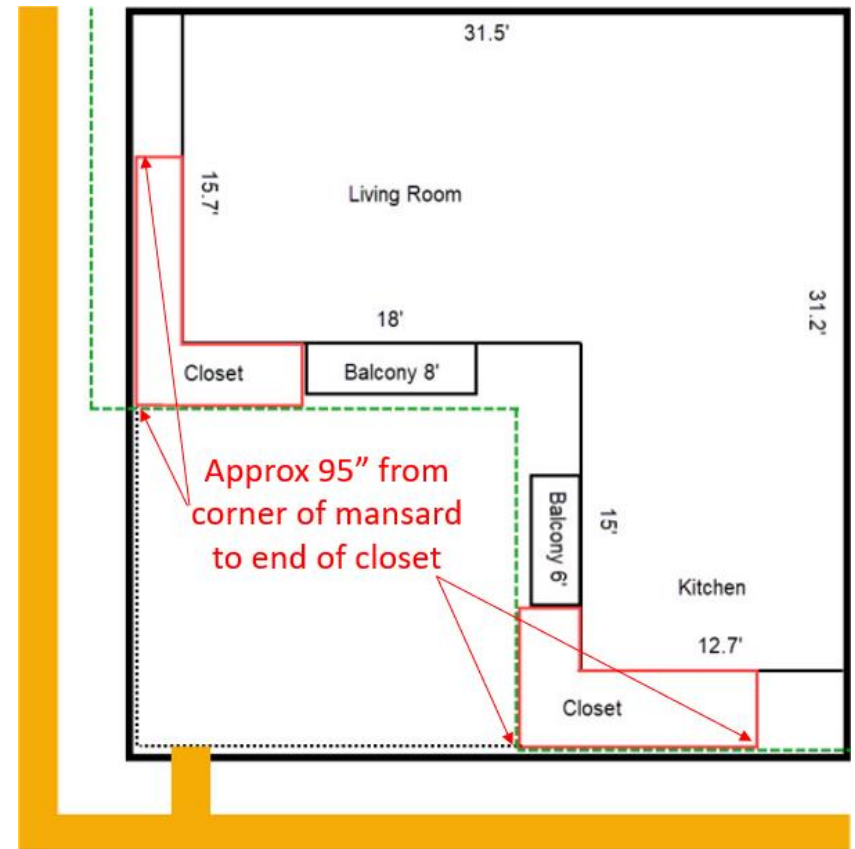

Extra Expanded Closets & Gate

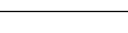
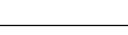

Legend:

Line Style	Picture	Description
Thick Black Line		Property line on your survey
Thin Black Line		Unit wall and balcony lines
Dashed Green Line		Roof line; distance between roof line and property line varies by unit. See your survey for exact measurements.
Dotted Black Line		Fence line
Thin Red Line		Closet walls
Thick Orange Line		Sidewalk

Note: Drawings not to scale